

**EXHIBIT DRAWING - LOTS 22A & 23A**  
**LAKE FOREST PHASE A-R3**  
 7124 Hill Forest Drive, Dallas, Texas

Date: July 28, 2010

Ref.# 01-2241-\_\_

Lot 19A

Lot 20A

Lot 16

Lot 15

BLOCK B/7462  
LAKE FOREST PHASE A-R3  
VOL. 2000020, PG. 2145

BLOCK C/7462  
LAKE FOREST PHASE A  
VOL. 98079, PG. 00079

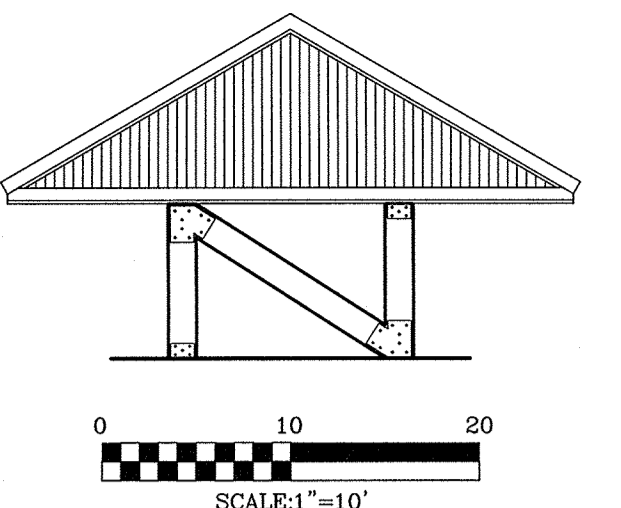

535.0 FILL  
537.0 FF

Lot 22A  
Block B/7462  
9,651 S.F./0.2216 AC.

Building Pad  
6,089 S.F.

528.7 FILL  
530.7 FF

Future Lot 23A  
Block B/7462  
8,317 S.F./0.1909 AC.

528.1 FF

$\Delta = 2'08'42''$   
 $R = 138.50'$   
 $T = 2.59'$   
 $L = 5.18'$   
 $CD = 5.18'$   
 $CB = S34'30'50''E$

5' Sidewalk Easement  
Vol.98079, Pg.00079

10' Wastewater & Drainage Easement

1' Screening Wall  
Maintenance Easement  
Vol. 98079, Pg. 00079

Wastewater & Drainage Easement Vol.98079,  
Pg.00079

SIDEWALK EASEMENT/  
COMMON AREA 3/  
40' BUFFER ZONE  
LAKE FOREST- PHASE A  
VOL. 98079, PG. 00079

FLOODWAY EASEMENT/  
COMMON AREA 1  
LAKE FOREST- PHASE A  
VOL. 98079, PG. 00079

25' Wastewater & Drainage Easement  
Vol. 98079, Pg. 00079

15' Wastewater Easement Vol.5737, Pg.474

FOREST LANE  
(VARIABLE WIDTH STREET)

EXHIBIT DRAWING - LOT 22A  
LAKE FOREST PHASE A-R3  
7124 Hill Forest Drive, Dallas, Texas

Date: July 28, 2010

Ref.# 01-2241-

Lot 19A

Lot 20A  
BLOCK B/7462  
LAKE FOREST PHASE A-R3  
VOL. 2000020, PG. 2145

Lot 16

Lot 15

BLOCK C/7462  
LAKE FOREST PHASE A  
VOL. 98079, PG. 00079

Lot 14

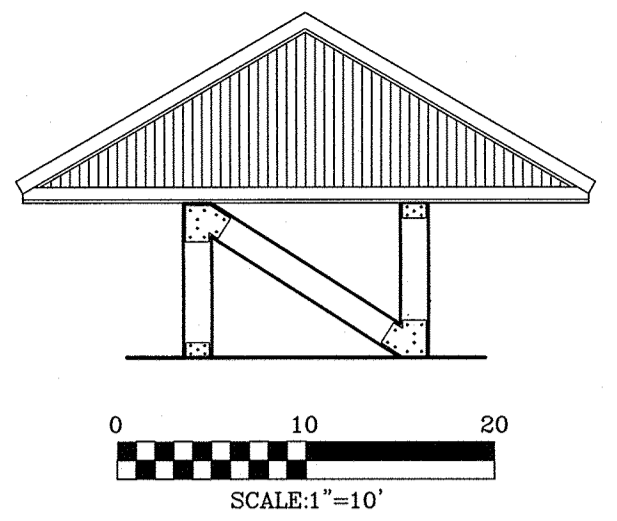

535.0 FILL  
537.0 FF

Future Lot 22A  
Block B/7462  
9,651 S.F./0.2216 AC.

3'x3' TUE Easement  
Vol.98079, Pg.00079

$\Delta = 21^{\circ}56'50''$   
 $R = 138.50'$   
 $T = 26.86'$   
 $L = 53.05'$   
 $CD = 52.73'$   
 $CB = S22^{\circ}28'04''E$

528.7 FILL  
530.7 FF

15' Wastewater Easement  
Vol.98079, Pg.00079

FLOODWAY EASEMENT/  
COMMON AREA 1  
LAKE FOREST- PHASE A  
VOL. 98079, PG. 00079

10' Wastewater &  
Drainage Easement

5' Sidewalk Easement  
Vol.98079, Pg.00079

HILL FOREST DRIVE  
(VARIABLE WIDTH PRIVATE STREET)

Lot 23A  
Block B/7462  
8,317 S.F./0.1909 AC.

$\Delta = 58^{\circ}02'35''$   
 $R = 56.50'$   
 $T = 31.35'$   
 $L = 57.24'$   
 $CD = 54.82'$   
 $CB = S40^{\circ}30'57''E$

Building Pad  
4,794 S.F.

528.1 FF

25' Wastewater &  
Drainage Easement  
Vol. 98079, Pg. 00079

$N43^{\circ}41'35''W$  12.33'

1' Screening Wall  
Maintenance Easement  
Vol. 98079, Pg. 00079

$\Delta = 20^{\circ}49'15''$   
 $R = 106.50'$   
 $T = 19.57'$   
 $L = 38.70'$   
 $CD = 38.49'$   
 $CB = S79^{\circ}56'52''E$

$S89^{\circ}38'30''W$  198.10'

Wastewater & Drainage Easement  
Vol.98079, Pg.00079

SIDEWALK EASEMENT/  
COMMON AREA 3/  
40' BUFFER ZONE  
LAKE FOREST- PHASE A  
VOL. 98079, PG. 00079

FOREST LANE  
(VARIABLE WIDTH STREET)

EXHIBIT DRAWING - LOT 23A

LAKE FOREST PHASE A-R3  
7124 Hill Forest Drive, Dallas, Texas

Date: July 28, 2010

Ref.# 01-2241-\_\_